

# GROM BT, AUX3(IPD3), AND2 NIS02 (SAT) ADAPTER USAGE MANUAL

**\*NOTE:** Playlist change, track info is available for AUX3 (IPD3) and BT3 units when they are used with the iPod cable, and AND2 units when they are used with the USB/ Android devices.

iPod cable ISIPD connects to the EXT2 port of IPD3/AUX3/BT3 device.

## To activate GROM adapter:

Press <<RADIO>> button until you are in XM mode

For proper STEERING WHEEL CONTROL operation:

While playing USB/Android/iPod, press and hold PRESET 1-6 one at a time until you hear a beep sound.

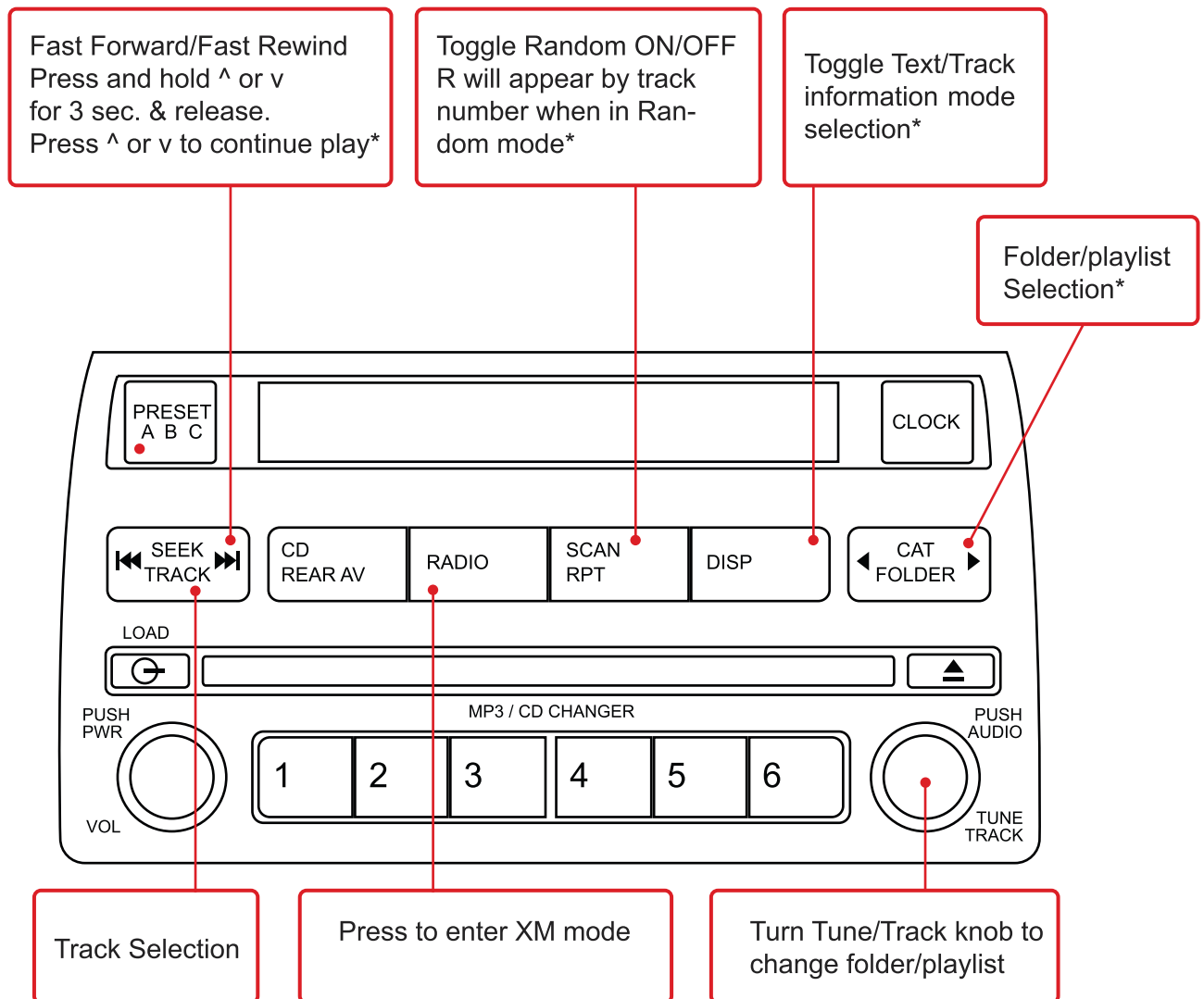

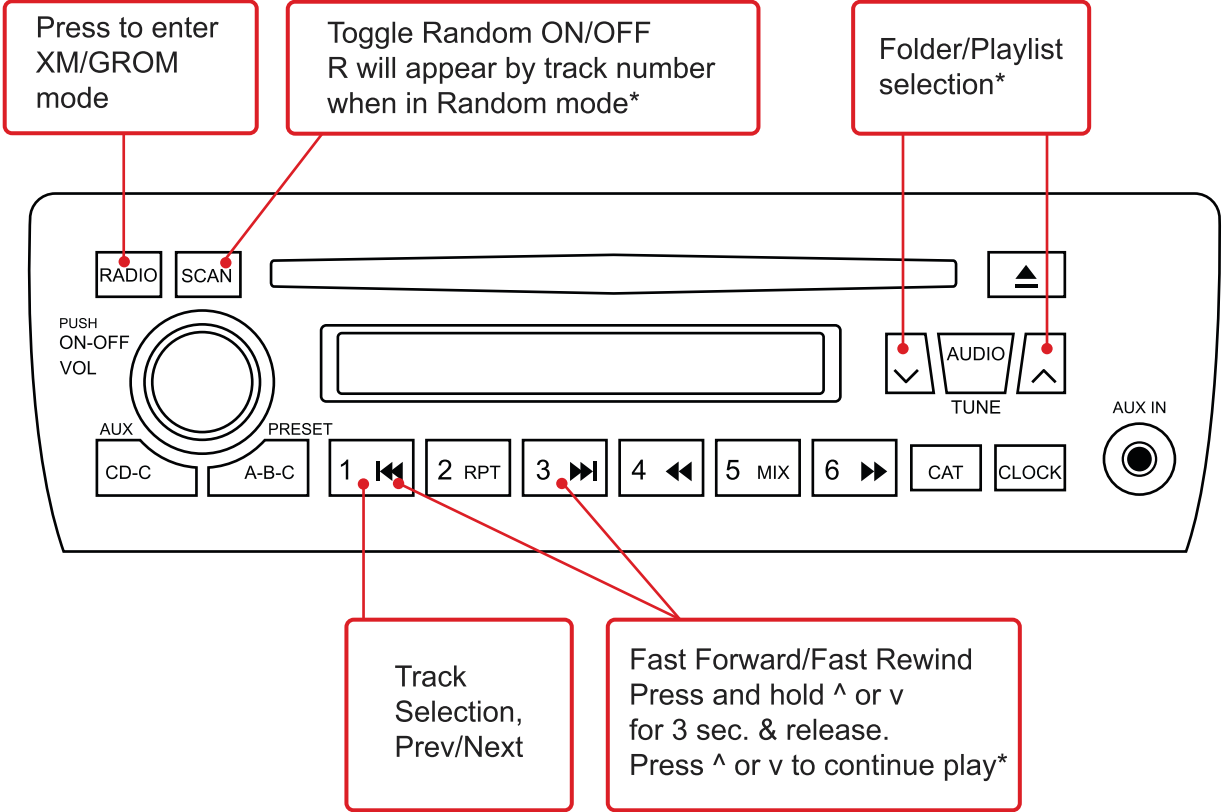
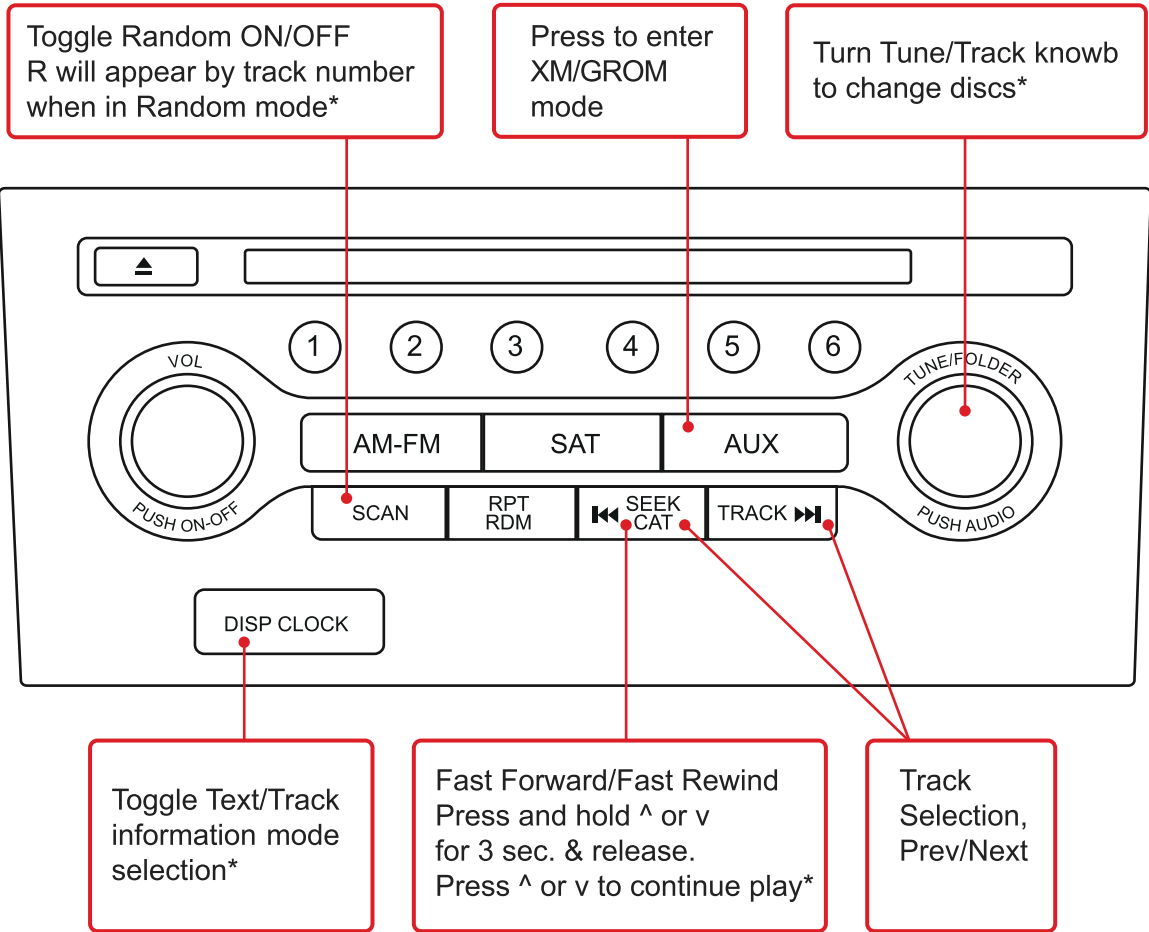

\*ISIPD for BT3/AUX3 is needed; USB/Android for AND2 is needed

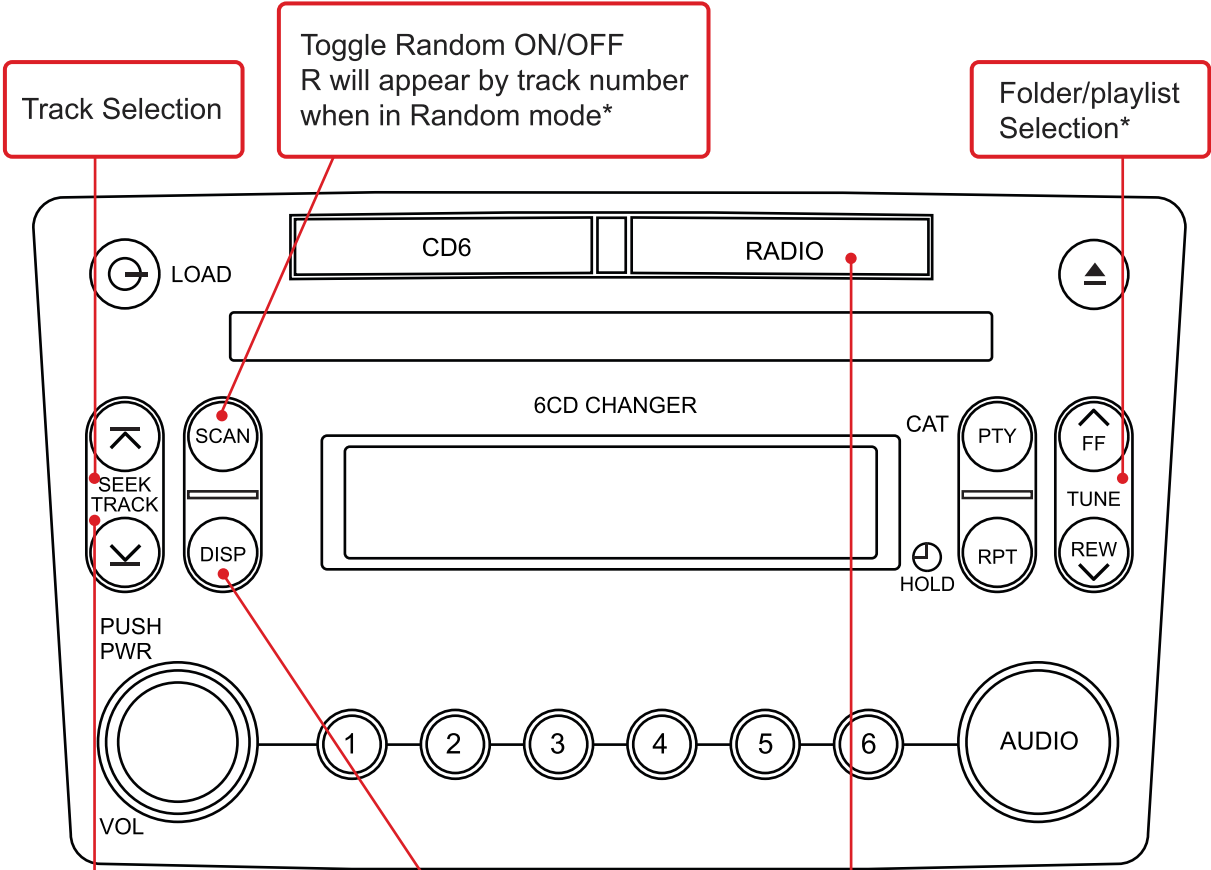

Fast Forward/Fast Rewind  
 Press and hold ^ or v for 3 sec. & release.  
 Press ^ or v to continue play\*

Toggle Text/Track information mode selection\*

Press to enter XM/GROM mode

Fast Forward/Fast Rewind. Press and hold ^ or v for 3 sec. & release. Press ^ or v to continue play\*

Toggle Text/Track information mode selection\*

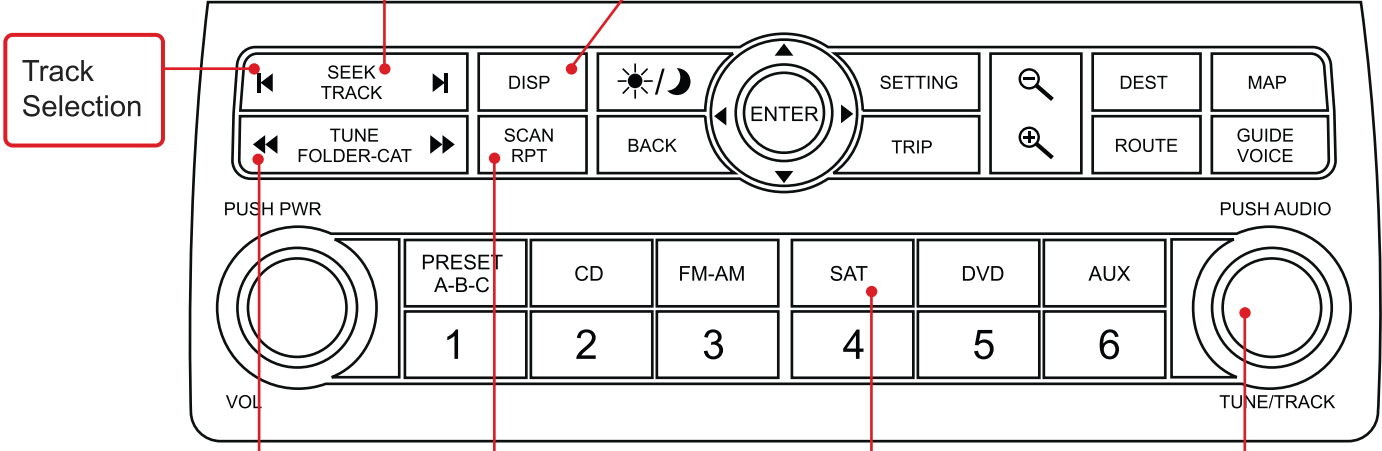

Folder/playlist Selection\*

Toggle Random ON/OFF  
 R will appear by track number when in Random mode\*

Press to enter XM/GROM mode

Turn Tune/Track knob to change discs/folders\*

\*ISIPD for BT3/AUX3 is needed; USB/Android for AND2 is needed

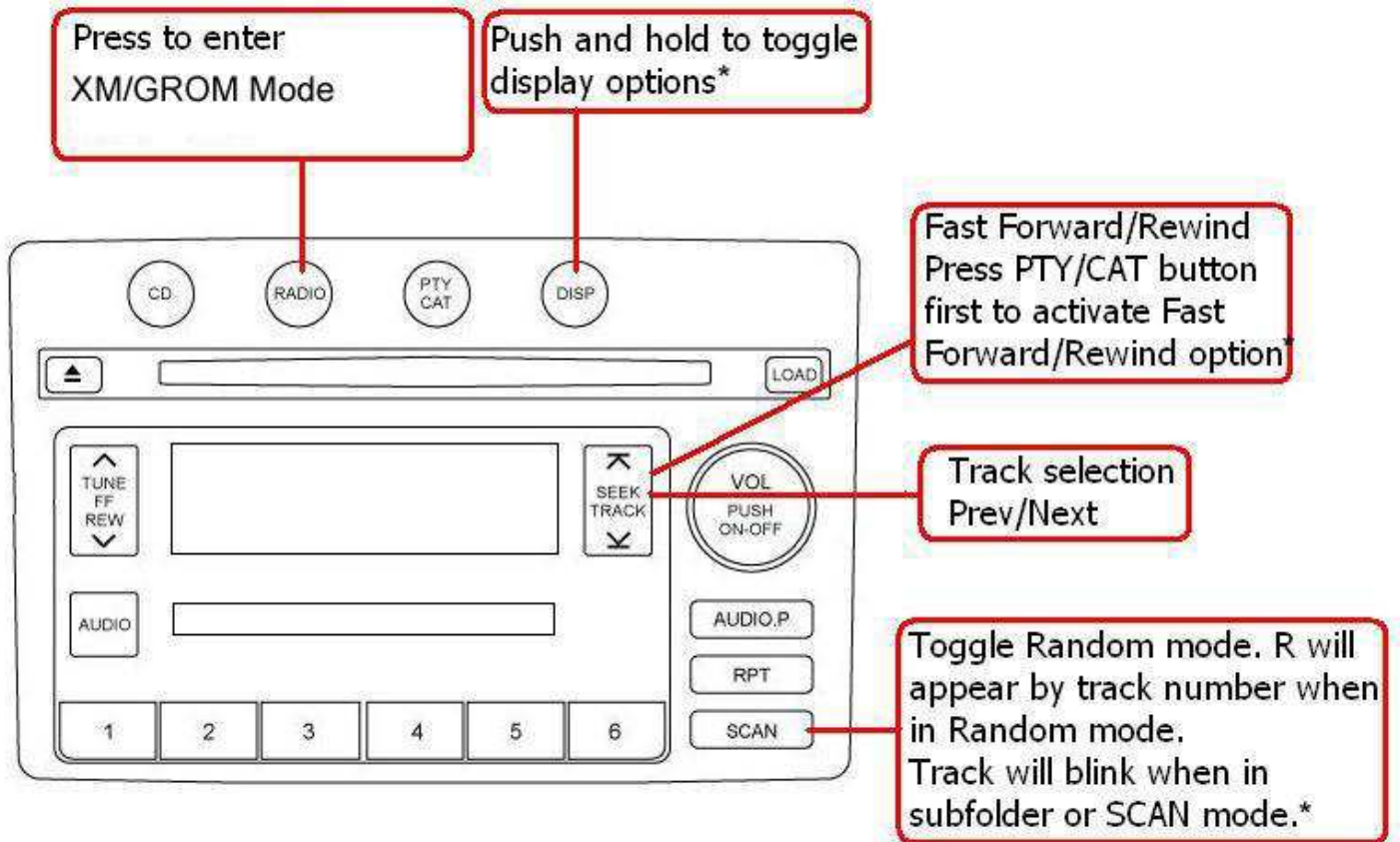

#### AUX connector usage note:

To use AUX connector on your GROM AUX3(IPD3), BT3 or AND2 device, follow to the next steps:

- connect the AUX cable to the GROM device
- disconnect any other music source
- turn on AUX music source, adjust the volume on your aux music source to the maximum

\*ISIPD for BT3/AUX3 is needed; USB/Android for AND2 is needed